

This is a reproduction of the original drawing. It is not to be used for construction purposes without the written consent of the architect. The architect is not responsible for any errors or omissions in this drawing. The architect is not responsible for any construction methods or materials used in the construction of the project. The architect is not responsible for any construction methods or materials used in the construction of the project. The architect is not responsible for any construction methods or materials used in the construction of the project.

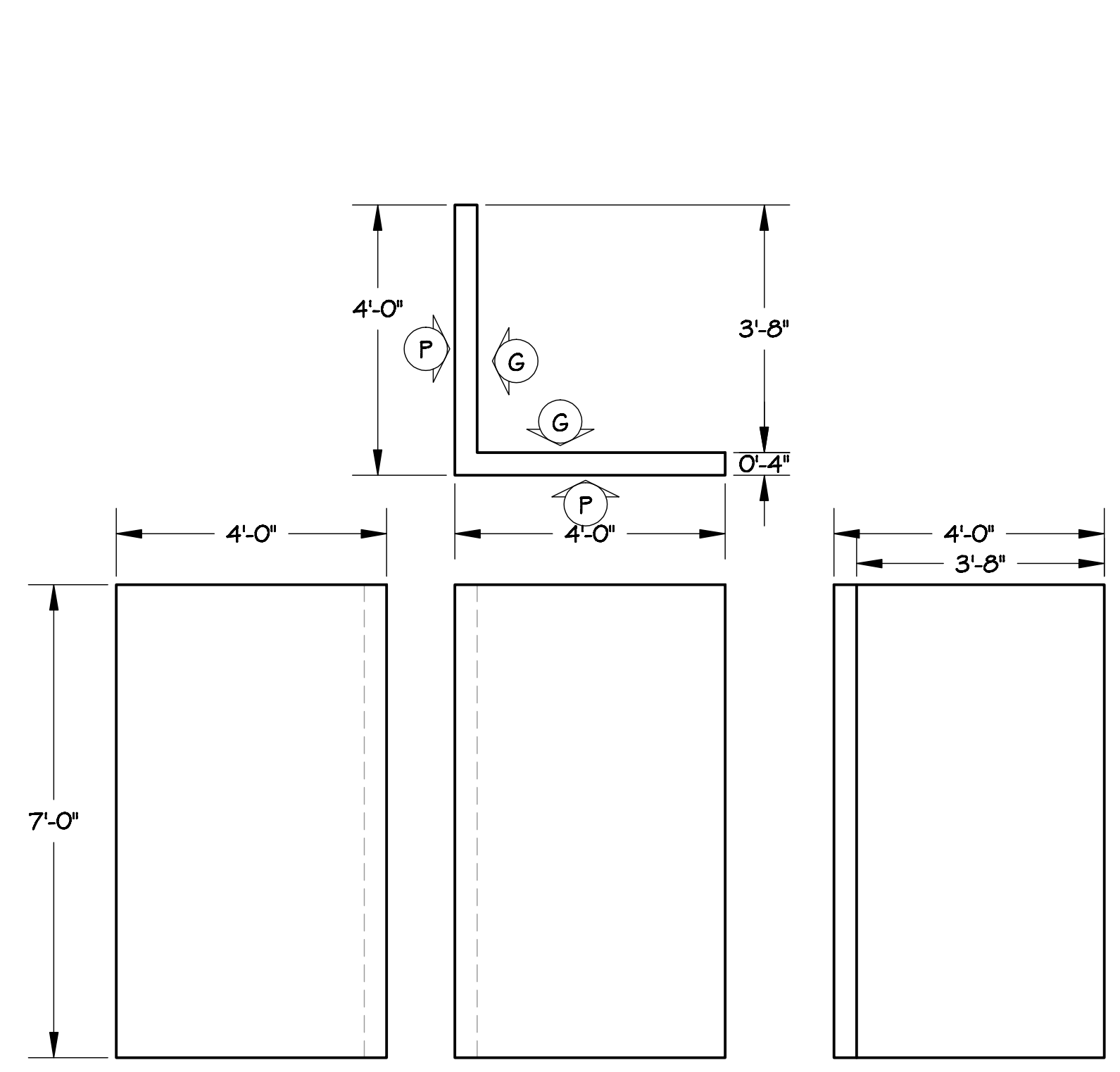

G

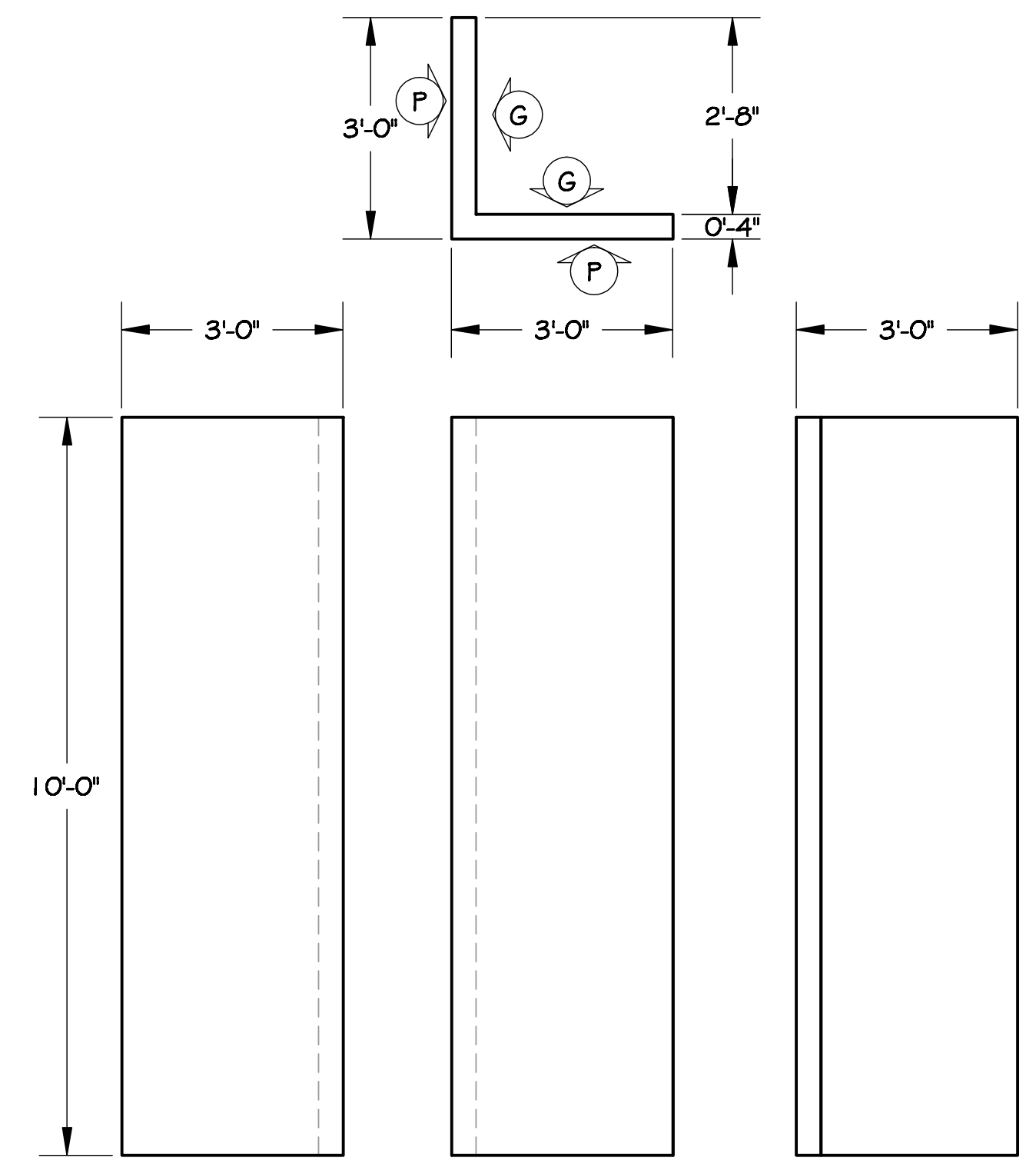

H

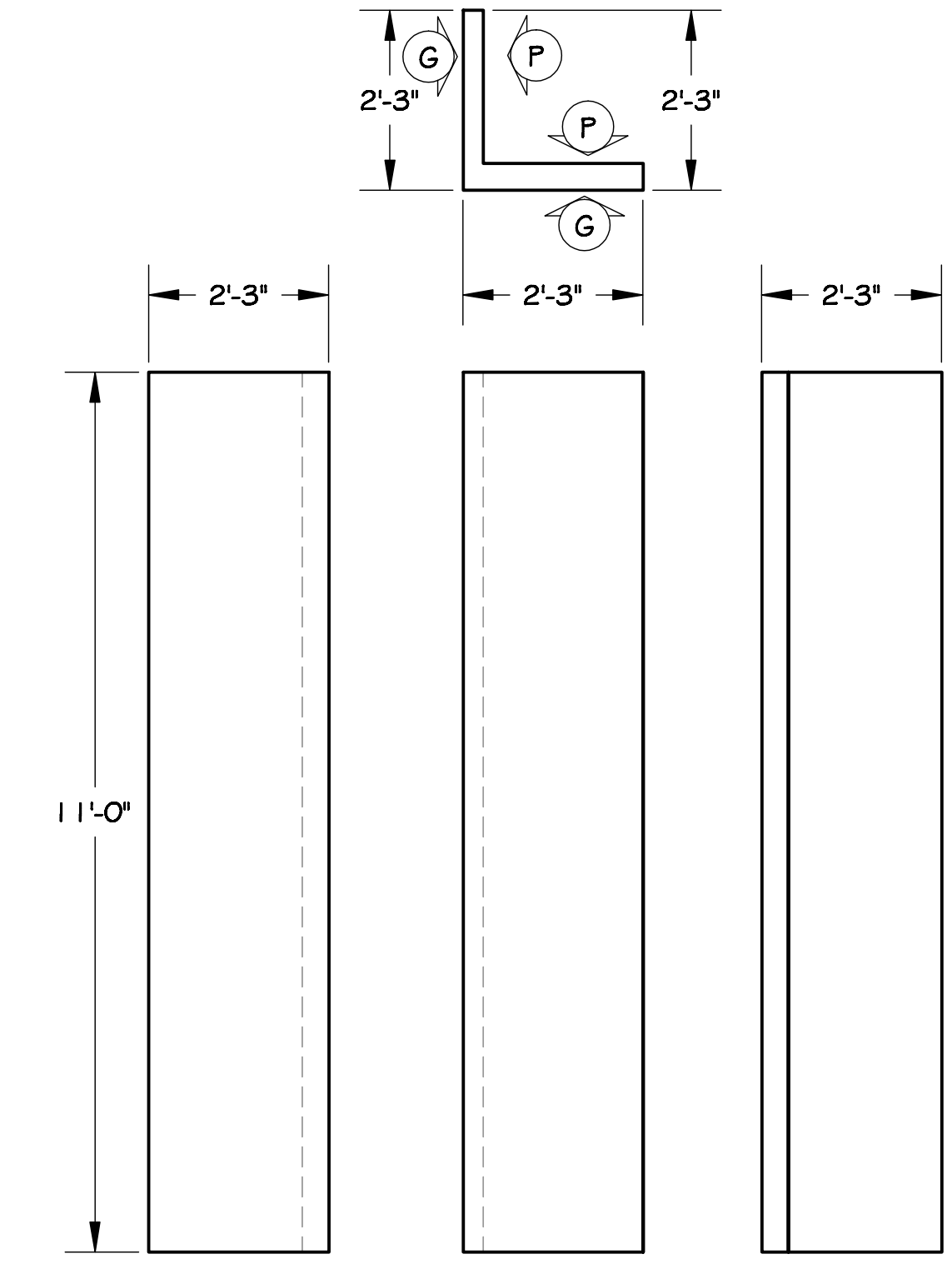

I

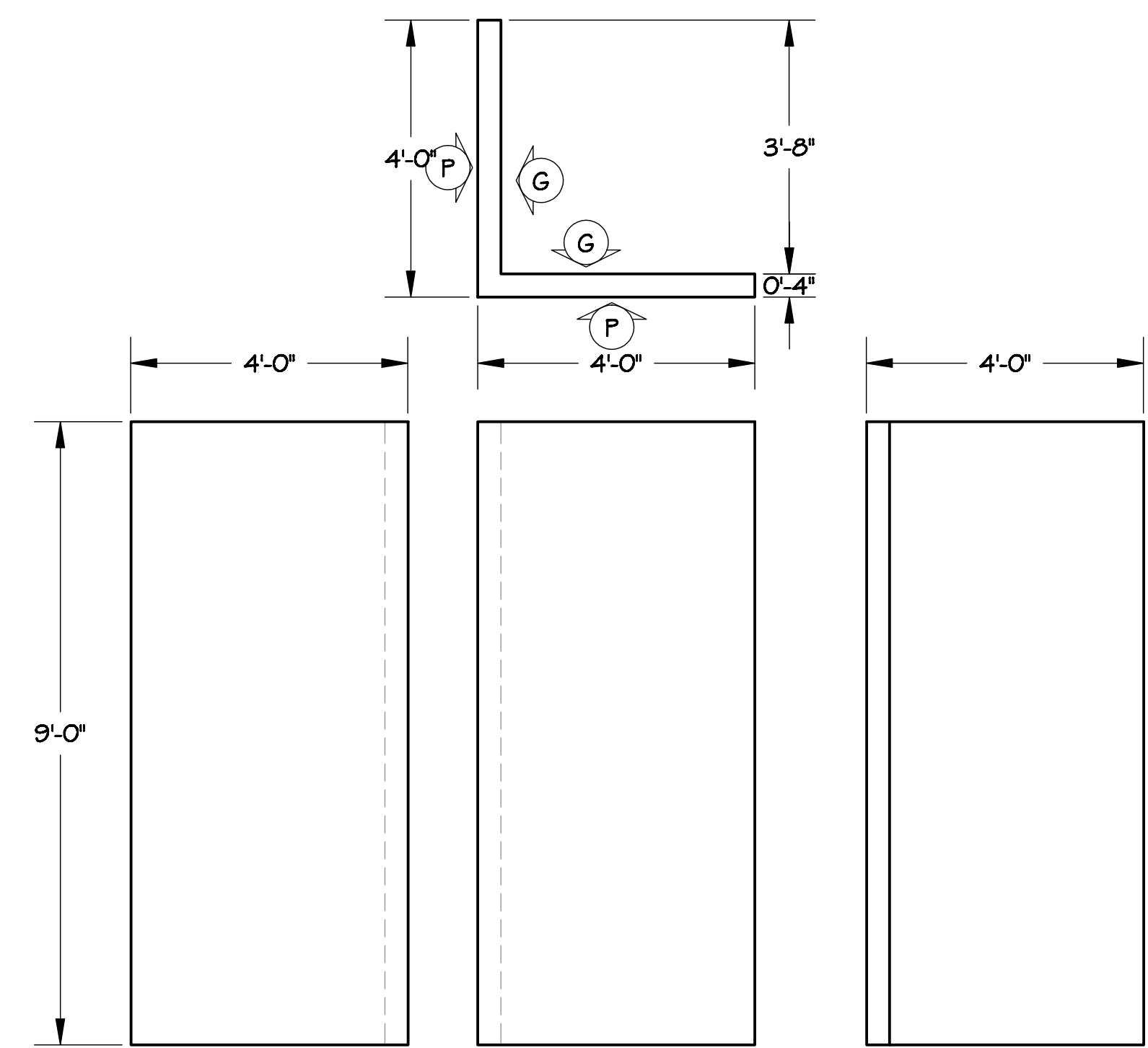

J

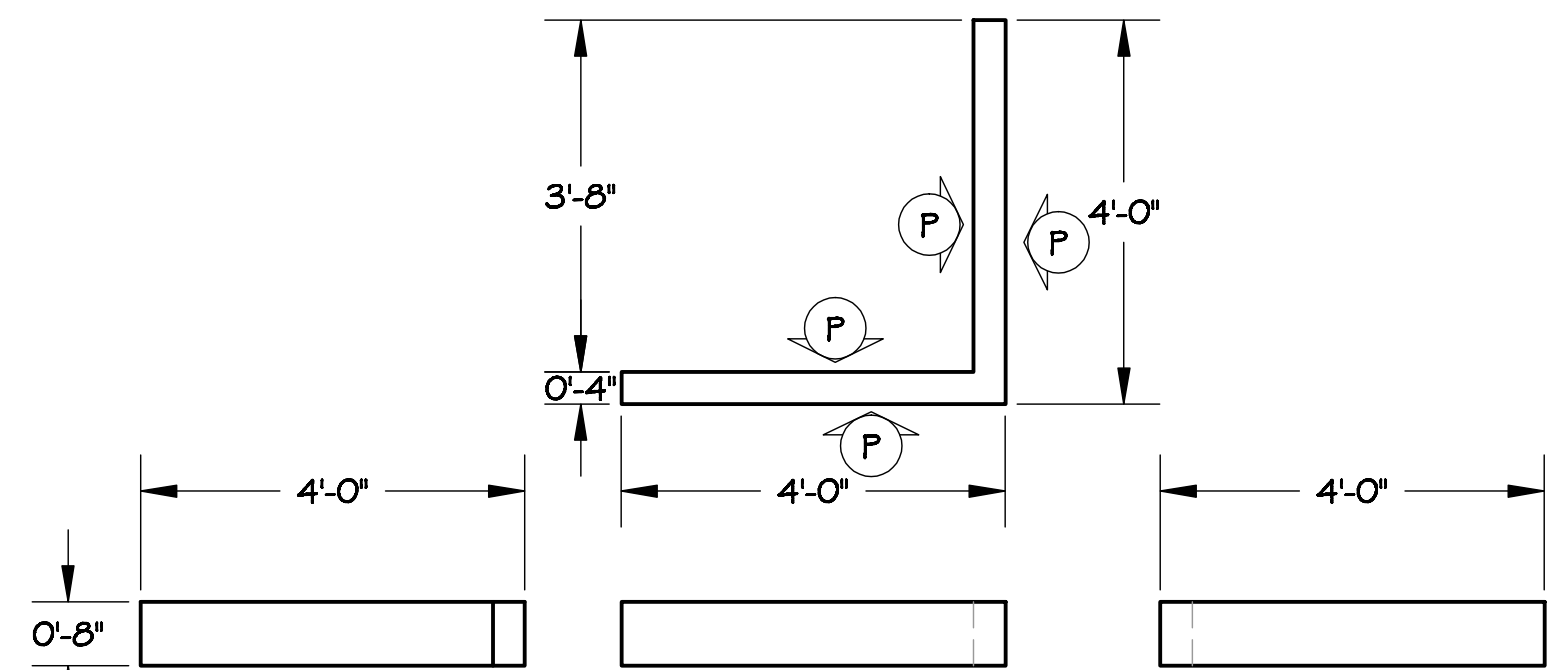

K

**Corners:**

Build one of each.

All walls will have a durable, concrete surface texture over which painted detail will be applied.

Surfaces marked (G) will be painted with rough concrete detail. See "Backside Elevation." These sides are not seen well or at all by the audience.

Surfaces marked (P) will be painted with architectural detail. Each side will have a separate elevation. See specific elevations for painted detail.

Corners will be placed on concrete floor and remain in position during the show.

**Revisions:**

**La Costa Theatre - Chicago**  
**Secret Agent**

**Details Corners G-K**

**Organic Theatre Company**

Director  
**Alexander Galan**  
DRAWN BY  
**TJM**  
DATE  
**13 March 2006**  
SCALE:  
**1/2" = 1'-0"**  
DRAWING NUMBER  
**4**  
DRAWING DATA