

This is a representation of design concepts only! The designer takes no responsibility, and hereby disclaims liability, for the erection, engineering and/or use of any component or concept shown on this or any other drawing. It is the responsibility of the wedding companies to erect this design using properly engineered and approved materials, components and methods, including but not limited to local building, fire and safety codes, and all applicable O.S.H.A. standards.

All concepts, ideas, and design elements shown on this drawing and any other documentation are the exclusive intellectual property of Scenographix, Ltd. and may only be used for this project. Any other use is prohibited, unless express written permission has been granted by Scenographix, Ltd.

Revisions:

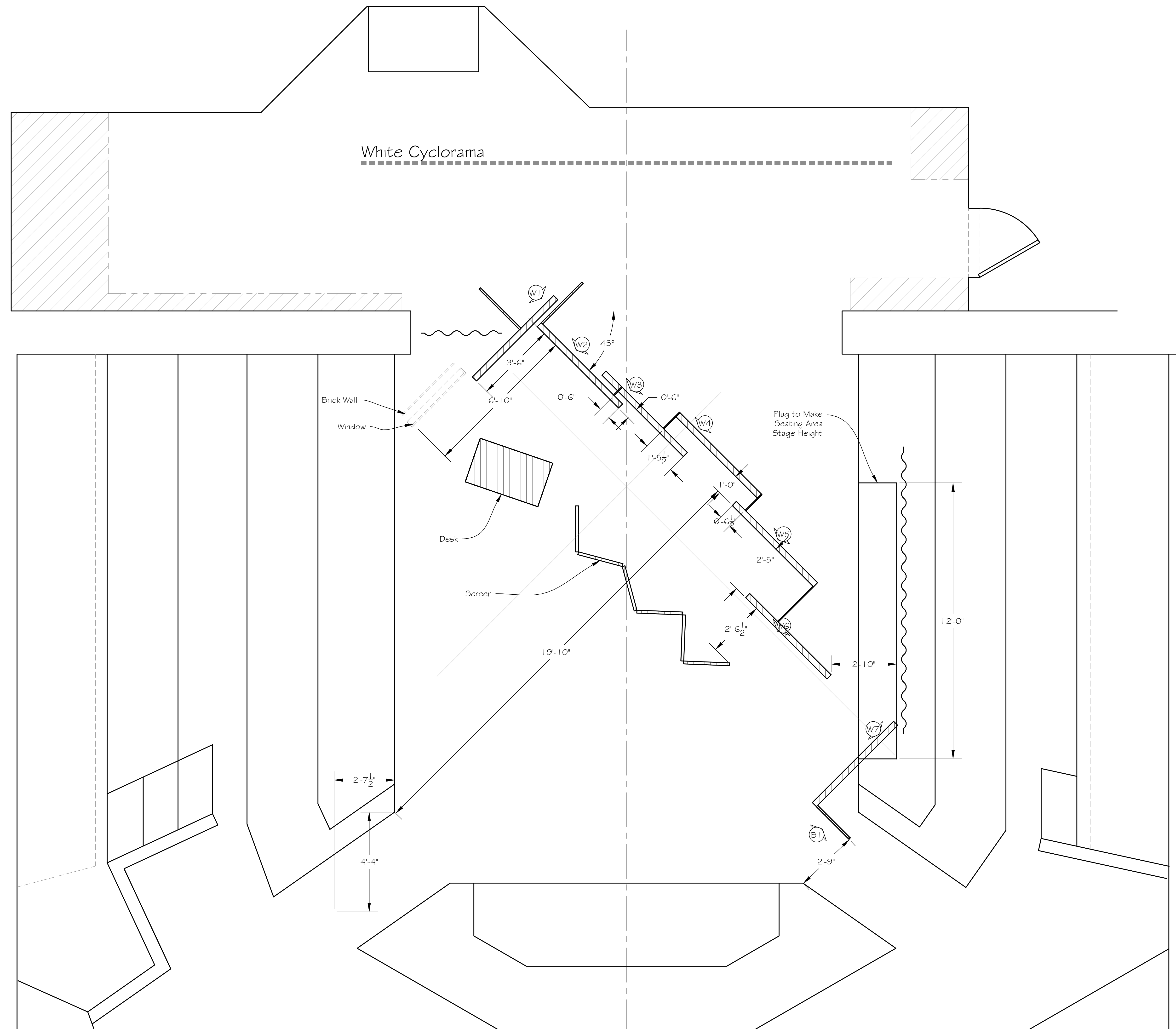

**North Central College-Naperville
Meilly Swallow Theatre
Bartleby
Plan**

Organic
Theatre
Company

Director
Alexander Gelman
DRAWN BY
TLM
DATE
27 January 2012
SCALE:
1/2" = 1'-0"
DRAWING NUMBER

1
DRAWING DATA