

The responsibility of the architect is to design the space, not to build it. The architect is responsible for the design, not for the construction. The architect is responsible for the design, not for the construction. The architect is responsible for the design, not for the construction.

Revisions:

Ruth Page Center for the Arts - Chicago
The Dressing Room
Views: Front, Perspective, Sections

Organic Theatre Company

Director
Alexander Golman
 Drawn by
TIM
 Date
15 February 2007
 Scale
3/8" = 1'-0"
 Drawing Number

2
 Drawing Data

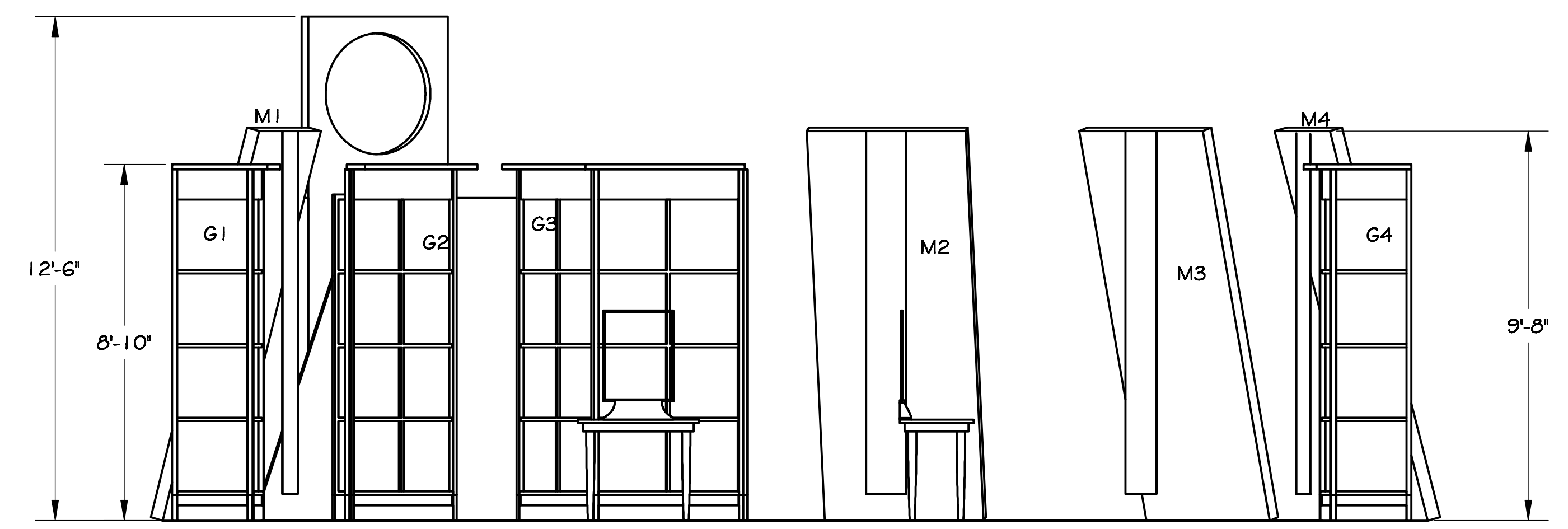
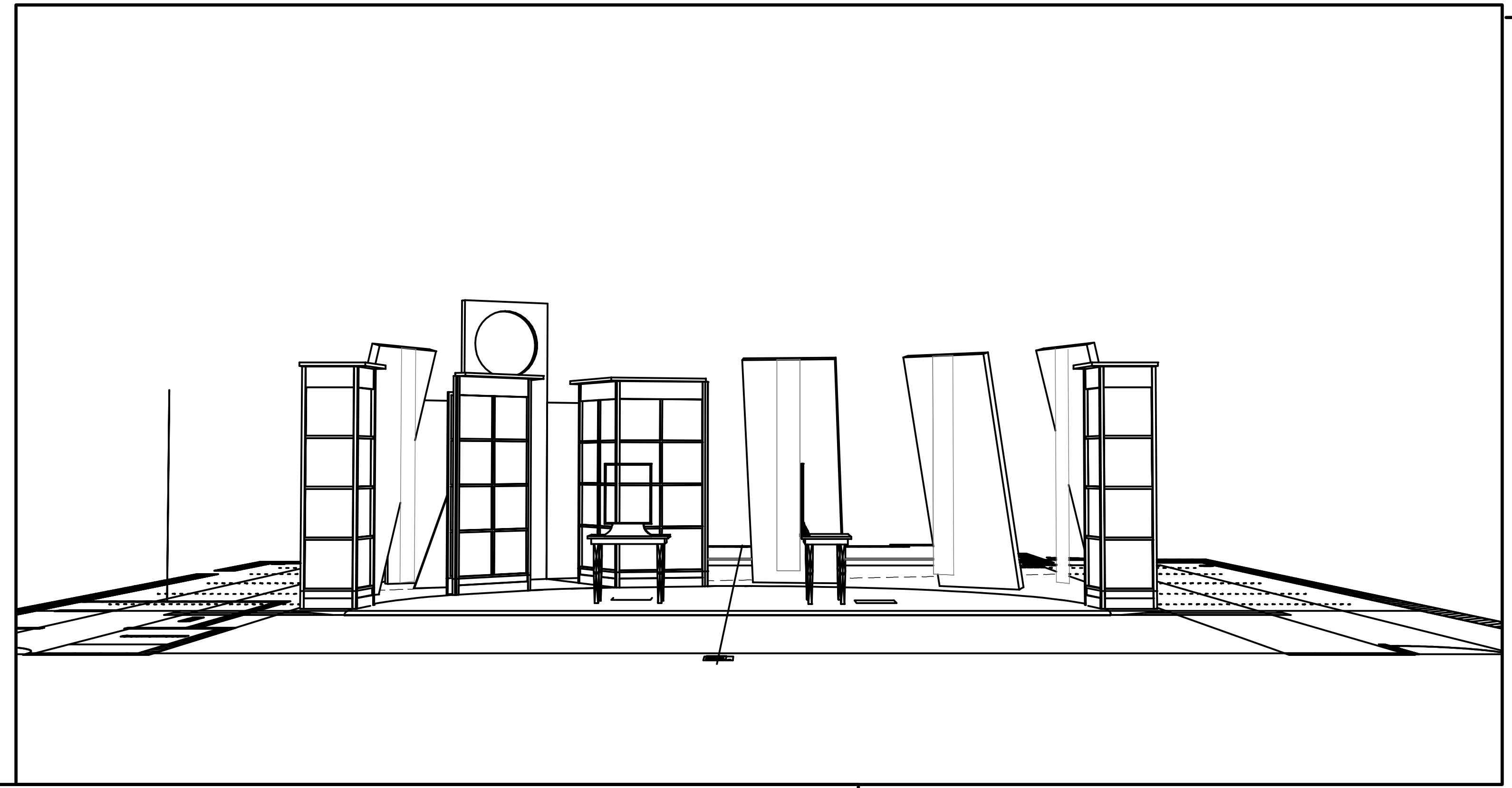
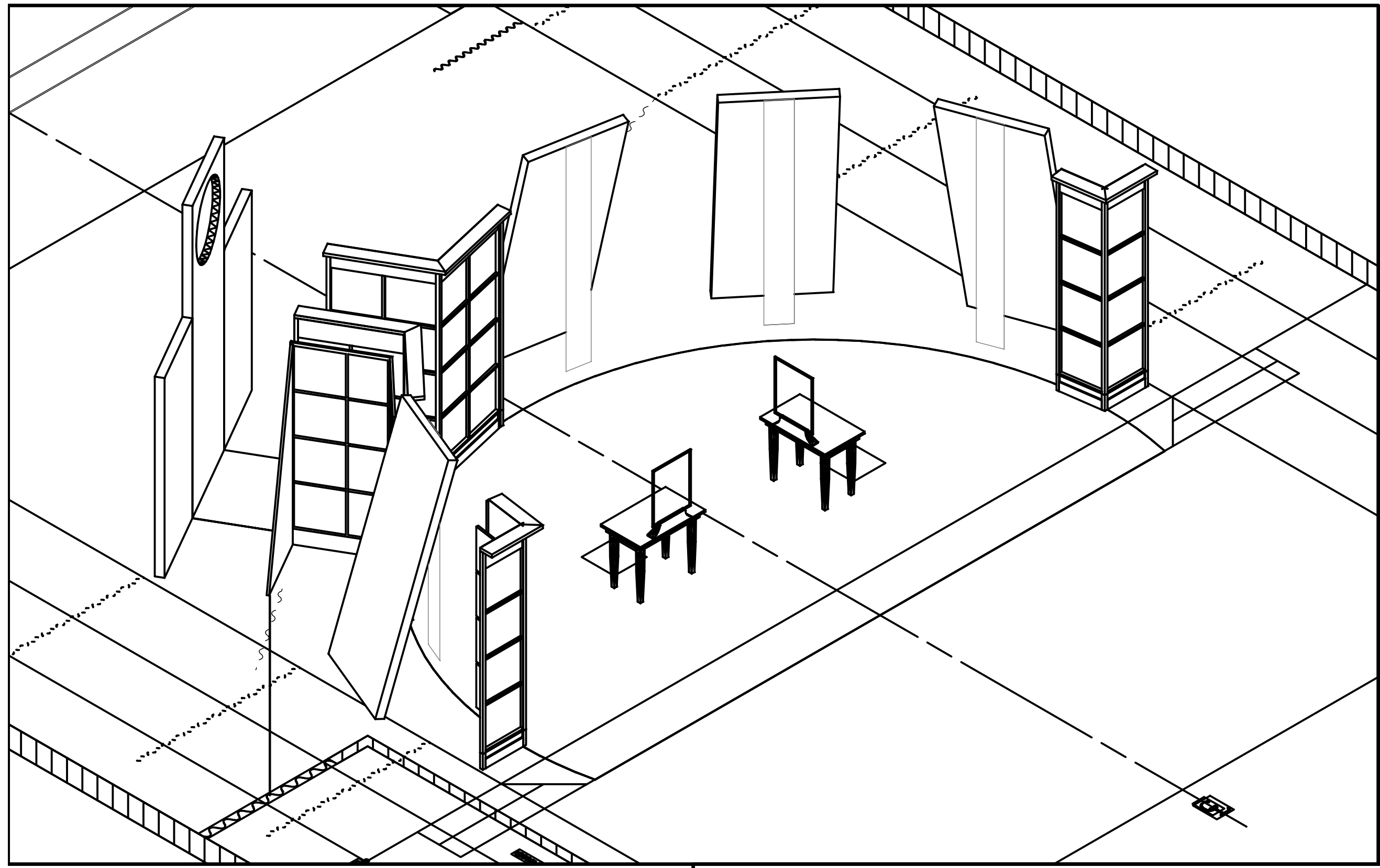

Front View

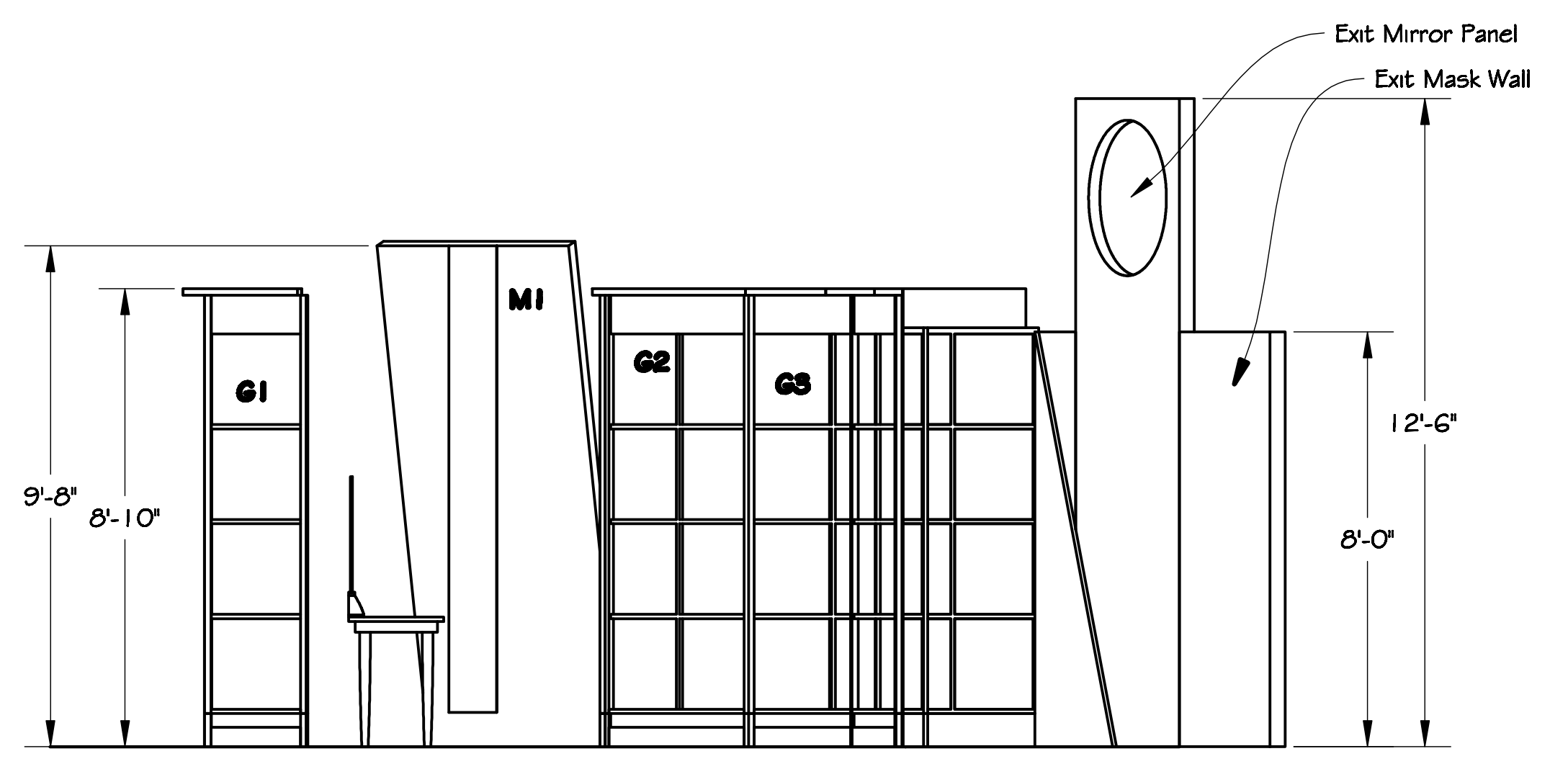

Center Section Looking S.R.

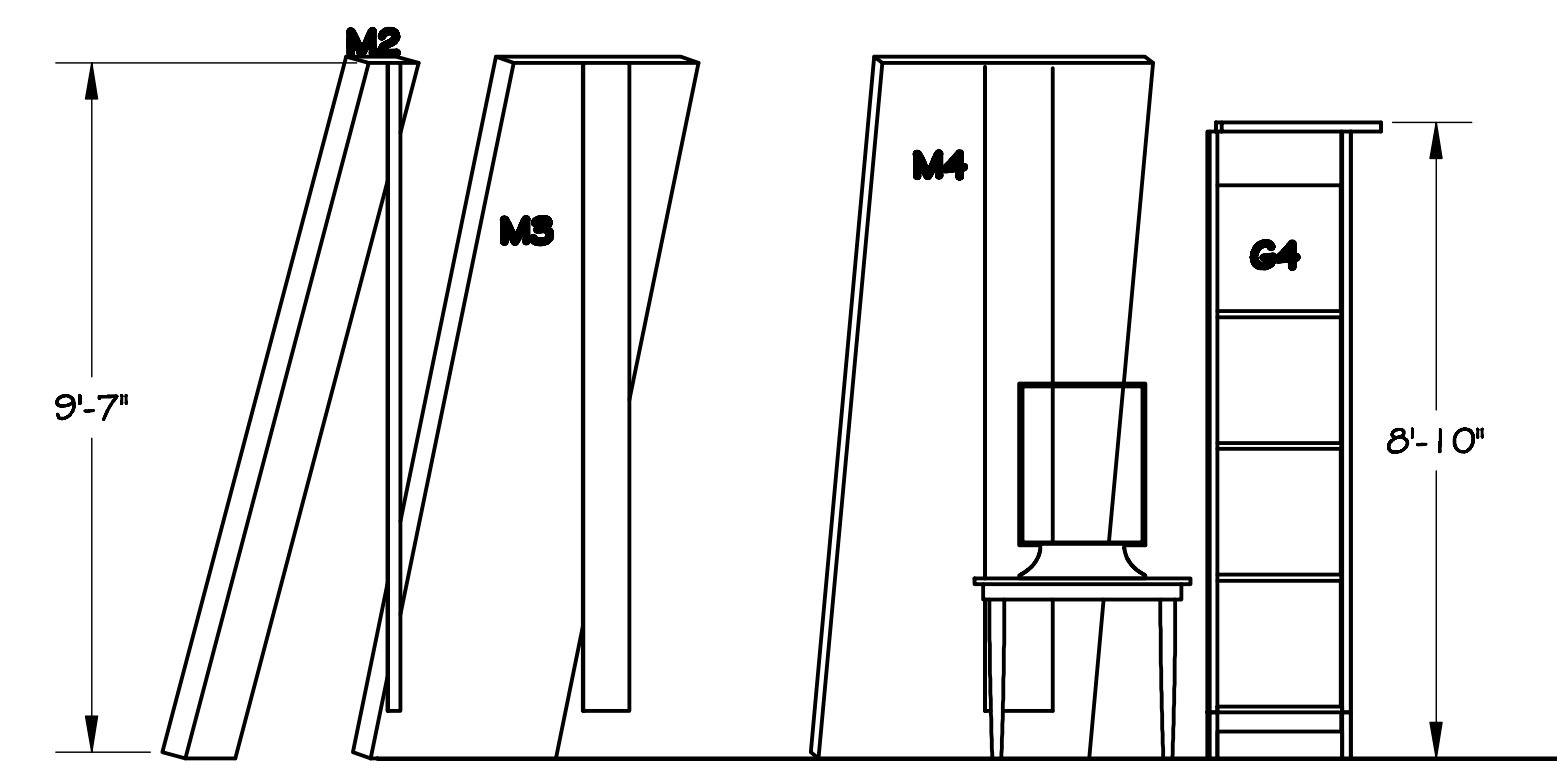

Center Section Looking S.L.